

"BC-02" 20 GA CHANNEL CAP W/
14. - 13 x 1.5" TRU DP1 12" O/C. W/
BUTYL SEALANT AT FLANGES
(MARRY TO VERTICAL SEALANT)

15.-13 x 1.3" TRU DP1 12" O/C
"BA-02" BASE ANGLE

NOTE: REFER TO DETAIL _E FOR
EDGE METAL ASSEMBLY
INFORMATION.

NOTE: BUTYL SEALANT AT WALL
JOINERY NOT SHOWN FOR CLARITY.
ENSURE ALL SEALANTS MARRY TO
CREATE A THERMAL ENVELOPE.

FILL VOID WITH ONE-PART
EXPANDING FOAM SEALANT

CONTINUOUS THERMAL
CUT FOR COLD STORAGE
APPLICATIONS

"WC-01" PANEL CLIP W/
() 1/4 - 14 x _ HWH DP3 W/O
WASHER AT PANEL JOINT

ADHERED ONEDEK® FLASHING (REFER TO
ADHERED WALL FLASHING DETAILS ON _/_)

1 1/2"
MIN. WELD
(CONTINUOUS)

ONEDEK® THERMOPLASTIC ROOF
MEMBRANE (SEE "ONEDEK®
ROOFING MEMBRANE" FOR
ATTACHMENT OPTIONS)

12. - 24 x _ PNC DP4 W/ "RP-01"
ROOF DECK PLATE (REFER TO
RD1 FASTENING SYSTEM)

4" MIN.

BUTYL TAPE

EAVE STRUT (NOT BY
ONEDEK® SUPPLIER)

PARAPET W/ EDGE METAL (HIGH EAVE; COLD-STORAGE)

(SECTION VIEW)

DETAIL: PARAPET W/ EDGE METAL (HIGH EAVE)

DATE:	09/04/24	SHEET:	1	OF	1
APPLICATION:	RD1 ROOF DECK, COLD-STORAGE	DRAWN BY:	MMF		
AWIP DETAIL NUMBER:	RDR-ACS-HEW-005				

929 ALDRIDGE ROAD
VACAVILLE, CA 95688
TEL: (707) 359-2280
FAX: (707) 359-2286
WWW.AWIPANELS.COM



"BC-02" 20 GA CHANNEL CAP W/
14. - 13 x 1.5" TRU DP1 12" O/C. W/
BUTYL SEALANT AT FLANGES
(MARRY TO VERTICAL SEALANT)

#14 x 1 1/2" UNIVERSAL
FASTENER 12" O/C

AF-55 FASCIA COVER (12'-0"
LENGTHS)

ANCHOR BAR EXTRUDED

CONTINUOUS THERMAL CUT,
ONE-PART EXPANDING FOAM
SEALANT, AND SUPPORT ANGLE
ARE REQUIRED FOR COLD
STORAGE APPLICATIONS ONLY

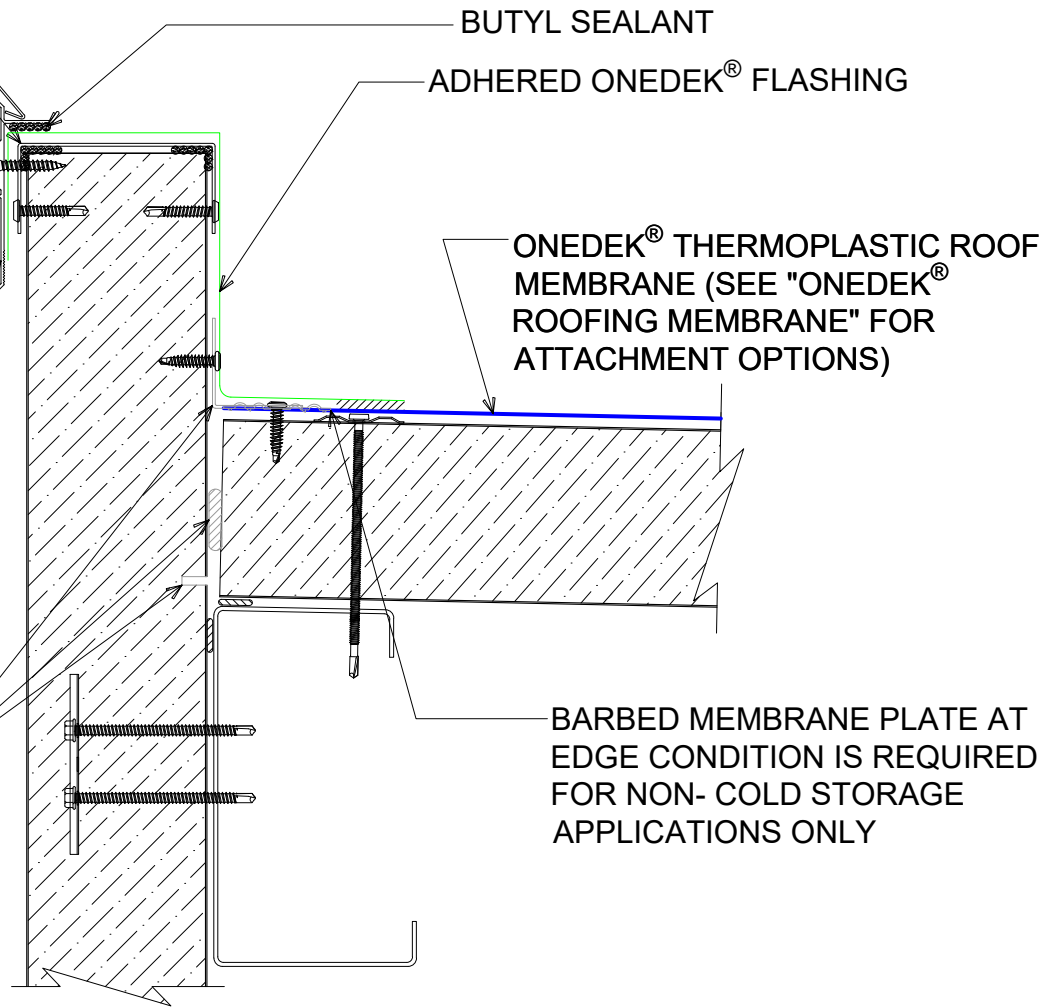

BUTYL SEALANT

ADHERED ONEDEK® FLASHING

ONEDEK® THERMOPLASTIC ROOF
MEMBRANE (SEE "ONEDEK®
ROOFING MEMBRANE" FOR
ATTACHMENT OPTIONS)

BARBED MEMBRANE PLATE AT
EDGE CONDITION IS REQUIRED
FOR NON- COLD STORAGE
APPLICATIONS ONLY

#E PARAPET W/ EDGE METAL (HIGH EAVE)

(SECTION VIEW)

DETAIL:

PARAPET W/ EDGE METAL (HIGH EAVE), AF-55

APPLICATION:

RD1 ROOF DECK, COLD-STORAGE

AWIP DETAIL NUMBER:

RDR-ACS-HEW-005

DATE:

09/04/24

DRAWN BY:

MMF

SHEET:

1

OF

1

929 ALDRIDGE ROAD
VACAVILLE, CA 95688
TEL: (707) 359-2280
FAX: (707) 359-2286
WWW.AWIPANELS.COM

All Weather
Insulated Panels



"BC-02" 20 GA CHANNEL CAP W/
14. - 13 x 1.5" TRU DP1 12" O/C. W/
BUTYL SEALANT AT FLANGES
(MARRY TO VERTICAL SEALANT)

#14 x 1 1/2" UNIVERSAL
FASTENER 12" O/C

AF-70 FASCIA COVER (12'-0"
LENGTHS)

ANCHOR BAR EXTRUDED

CONTINUOUS THERMAL CUT,
ONE-PART EXPANDING FOAM
SEALANT, AND SUPPORT ANGLE
ARE REQUIRED FOR COLD
STORAGE APPLICATIONS ONLY

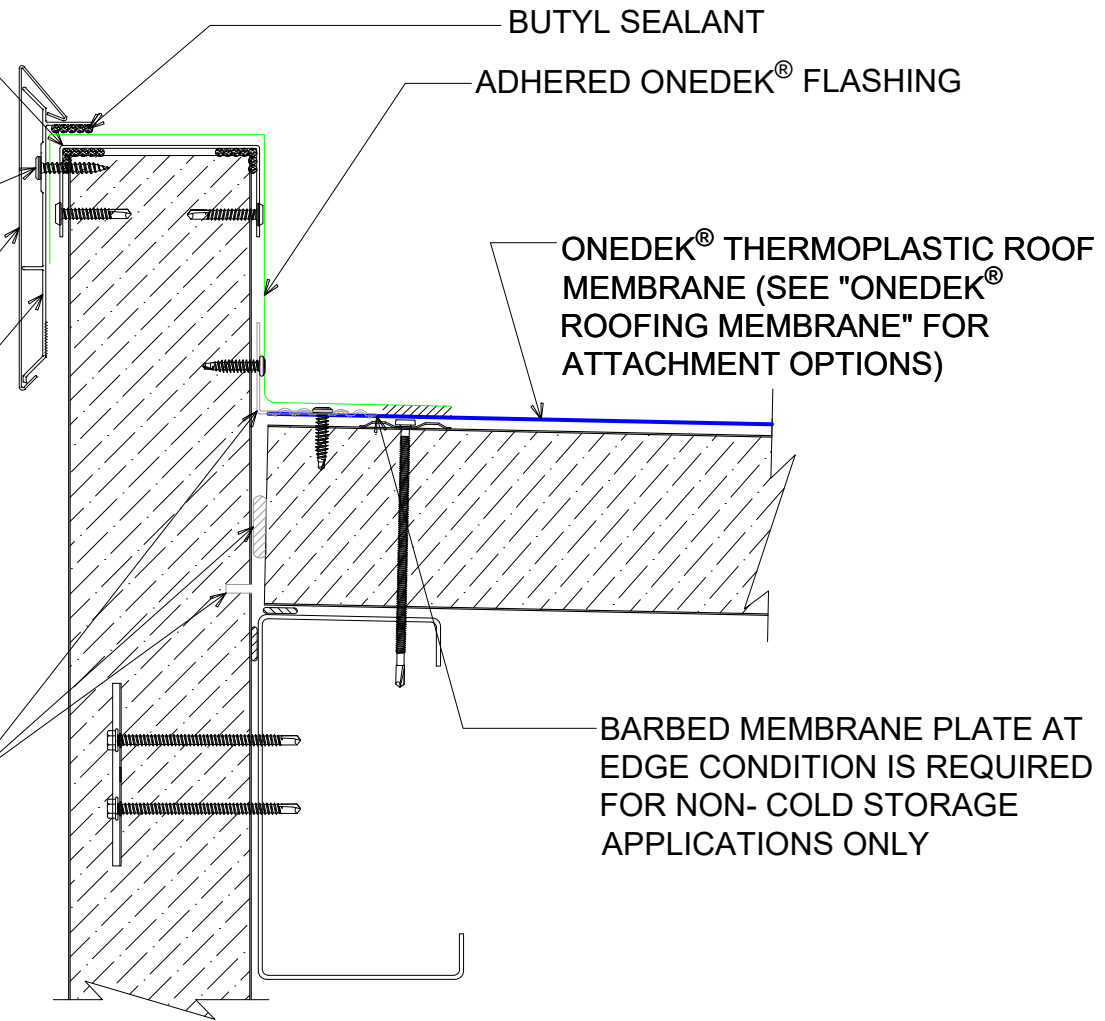

#E PARAPET W/ EDGE METAL (HIGH EAVE)

(SECTION VIEW)

DETAIL: PARAPET W/ EDGE METAL (HIGH EAVE), AF-70

DATE:	09/04/24	SHEET:	1	OF	1
APPLICATION:	RD1 ROOF DECK, COLD-STORAGE	DRAWN BY:	MMF		
		AWIP DETAIL NUMBER:			
		RDR-ACS-HEW-005			

929 ALDRIDGE ROAD
VACAVILLE, CA 95688
TEL: (707) 359-2280
FAX: (707) 359-2286
WWW.AWIPANELS.COM

All Weather
Insulated Panels